

Unified Thread (Unit - Inches)

Part Number (steel)	Thread Size	Grip Range Min. Max.	L ±.015	HD ±.025	HT ±.003	D Max.	IL Max.	HOLE SIZE +.004/- .000
CAH2-2520-260	1/4-20 UNC	.165 .260	.685	.510	0.30	.374	.400	.375

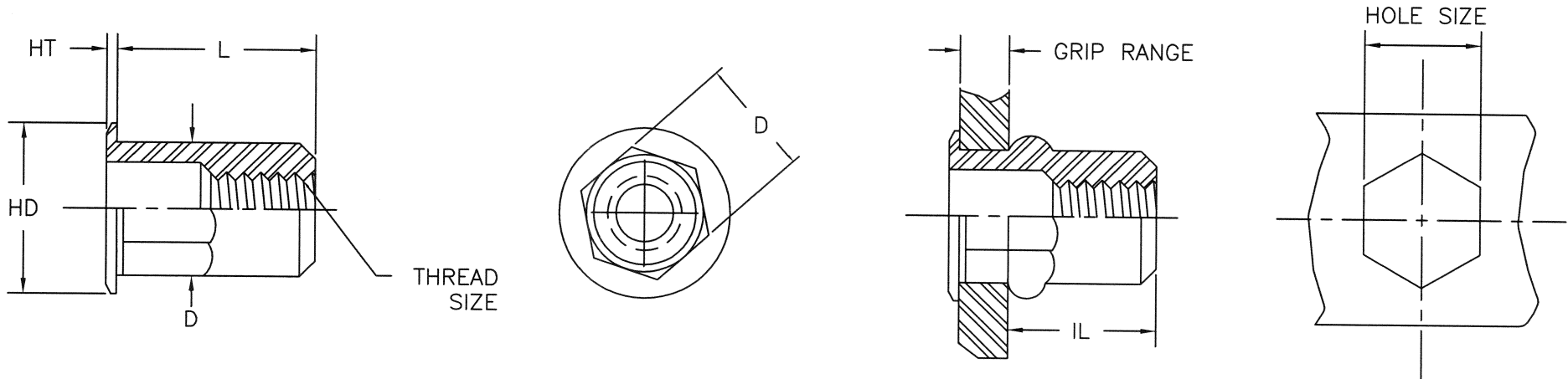

CAH Specifications Material: Steel 1008/1010 Stainless Steel 302 Aluminum 5056 Finish: Zinc Plated-Yellow Dichromate per ASTM B633 Fe/Zn 8, Type II		Part Number Description CAH2-2520-260 CAH Product Style 2 Semi Hex Material 2520 Thin Wall Series 1-Stainless Steel 2-Steel 3-Aluminum						260 Grip Range	(-) Empty-Open End B-Closed End
---	--	---	--	--	--	--	--	-------------------	---------------------------------------

THIS DRAWING, AND THE INFORMATION CONTAINED HERIN, ARE THE PROPERTY OF SHEREX FASTENING SOLUTIONS AND ARE NOT TO BE USED IN ANY MANNER DETRIMENTAL TO THE INTEREST OF THE COMPANY.
 NOTE: SHEREX RESERVES THE RIGHT TO REVISE PART/DRAWING WITHOUT NOTICE.

SHEREX FASTENING SOLUTIONS
 1400 COMMERCE PKWY.
 LANCASTER, NY 14086 USA



				DRAWN BY: JLA DATE: 8/11/03 SCALE: 1:1 TITLE: CAH STYLE RIVET NUT	E-mail: info@sherex.com www.sherex.com Phone: 866-474-3739 Fax: 716-681-0270	DRAWING NO. CAH2-2520-260								
				CHECK'D BY: JLA DATE: 8/11/03										
APPR'D BY: AJP DATE: 8/11/03	<table border="1"> <thead> <tr> <th>REV</th> <th>DESCRIPTION</th> <th>ECN</th> <th>DATE</th> </tr> </thead> <tbody> <tr> <td> </td> <td> </td> <td> </td> <td> </td> </tr> </tbody> </table>			REV	DESCRIPTION	ECN	DATE							
REV	DESCRIPTION	ECN	DATE											