

REVISIONS				
REV.	DESCRIPTION	DATE	ECN	INITIALS
A	INITIAL RELEASE	9/3/24	4526	PMZ

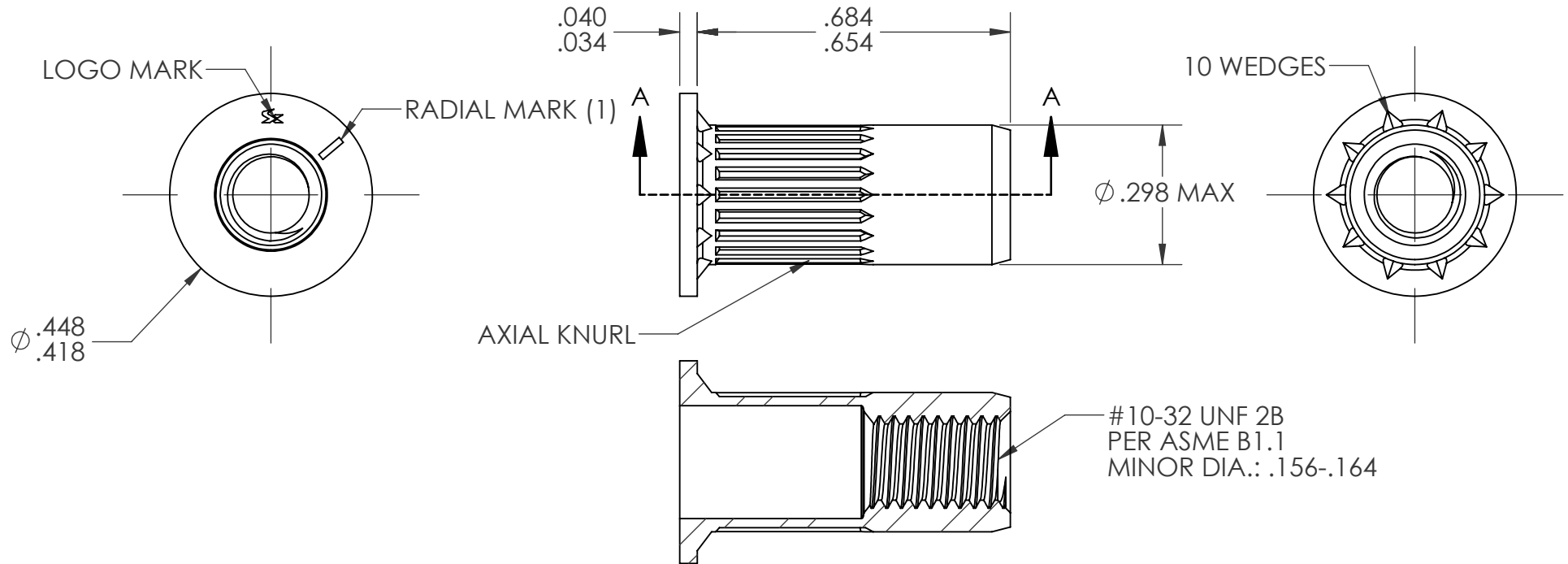

NOTE:

1. GRIP RANGE: .118-.217
2. HOLE SIZE: .300 +.006/-.000 AFTER ALL APPLIED FINISHES.
3. INSTALLED LENGTH: .413 MAX.
4. LUBRICATION: NONE
5. INSTALLATION TOOL: SPIN PULL

SECTION A-A

CUSTOMER APPROVAL:

DATE:

UNLESS OTHERWISE SPECIFIED:

DIMENSIONS ARE IN INCHES
TOLERANCES:
ANGULAR: MACH ± 1 BEND ± 1
TWO PLACE DECIMAL $\pm .01$
THREE PLACE DECIMAL $\pm .005$

INTERPRET GEOMETRIC
TOLERANCING PER:
ASME Y14.5M-1994

MATERIAL
302 STAINLESS

FINISH
NONE

DO NOT SCALE DRAWING

NAME

DATE

DRAWN

PMZ

9/3/24

CHECKED

ENG APPR.

JVK

9/3/24

MFG APPR.

Q.A.

COMMENTS:

E-mail: info@sherex.com
www.sherex.com
Phone: 866-474-3739
Fax: 716-875-0358



TITLE:

#10-32 OPEN END LARGE
FLANGE OPTISERT

SIZE DWG. NO.

A

OPT1-1032-217

REV

A

SCALE: 3:1 WEIGHT:

SHEET 1 OF 1