

REVISIONS				
REV.	DESCRIPTION	DATE	ECN	INITIALS
A	INITIAL RELEASE	9/24/25	4708	JLC

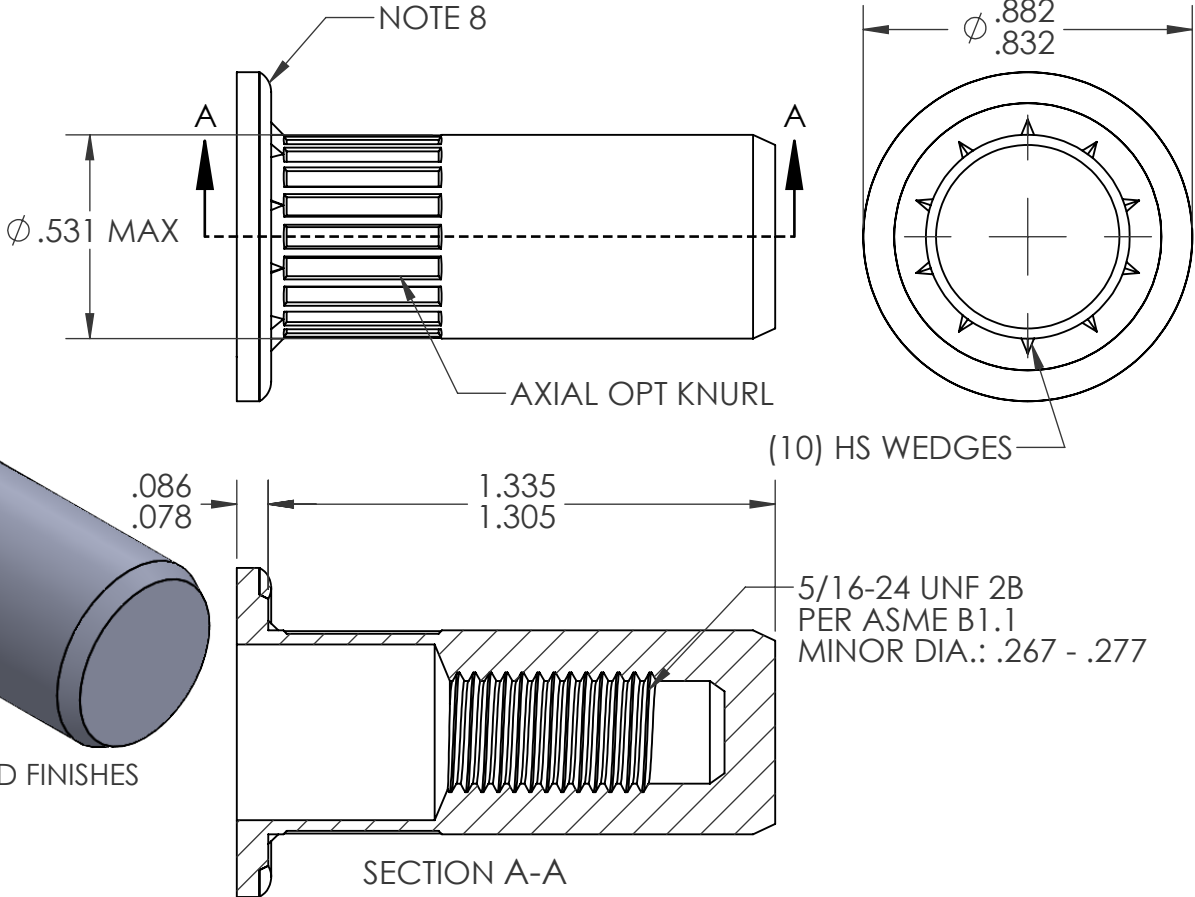
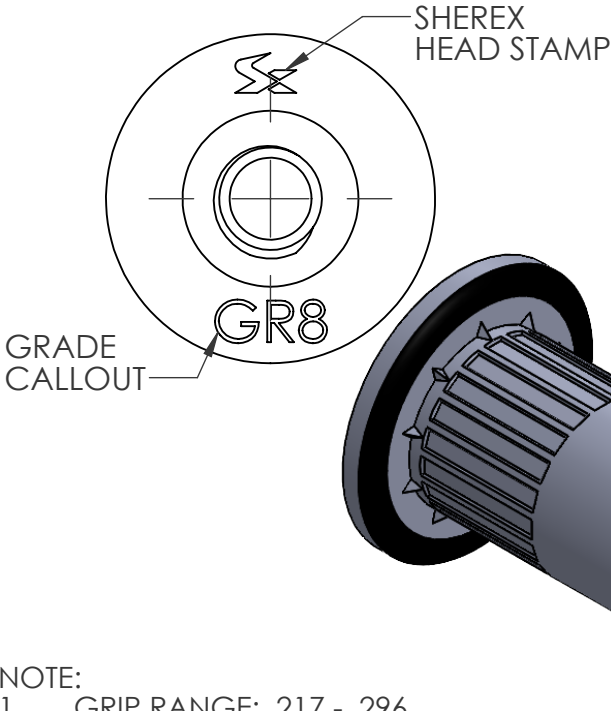

- NOTE:
- GRIP RANGE: .217 - .296
 - HOLE SIZE: .531 +.006/-.000 AFTER ALL APPLIED FINISHES
 - INSTALLED LENGTH: .965 MAX
 - INSTALLED THREAD DEPTH: .881 REF.
 - LUBRICATION: NONE
 - INSTALLATION TOOL: FLEX 5 SPIN PULL
 - THREAD MEETS GRADE 8 PROOF LOAD PER SAE J995: 8700LBF
 - DEPOSIT PLASTISOL ALONG OUTER GROOVE OF THE HEAD

PROPRIETARY AND CONFIDENTIAL

THIS DRAWING, AND THE INFORMATION CONTAINED HEREIN, ARE THE PROPERTY OF SHEREX AND ARE NOT TO BE USED IN ANY MANNER DETRIMENTAL TO THE INTEREST OF THE COMPANY.

SHEREX SOLUTIONS RESERVES THE RIGHT TO REVISE PART/DRAWING WITHOUT NOTICE.

UNLESS OTHERWISE SPECIFIED, ALL SPECIFICATIONS REFERENCED ON THIS DRAWING WILL PERTAIN TO THE MOST RECENT AND ACTIVE REVISION.

		UNLESS OTHERWISE SPECIFIED:		NAME	DATE
		DIMENSIONS ARE IN INCHES TOLERANCES: ANGULAR: MACH ± 1 BEND ± 1 TWO PLACE DECIMAL ± .01 THREE PLACE DECIMAL ± .005		DRAWN	JLC 5/28/25
		INTERPRET GEOMETRIC TOLERANCING PER: ASME Y14.5M-1994		CHECKED	
		MATERIAL		ENG APPR.	JVK 5/28/25
		10B21 STEEL		MFG APPR.	
		FINISH		Q.A.	
		ZINC PLATE CLEAR TRIVALENT CHROMATE PER SFS-01-001, SC1		COMMENTS:	
				E-mail: info@sherex.com	
				www.sherex.com	
				Phone: 866-474-3739	
				Fax: 716-875-0358	
NEXT ASSY		USED ON			
APPLICATION		DO NOT SCALE DRAWING			

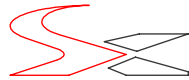

TITLE:

LARGE FLANGE ROUND BODY

SIZE	DWG. NO.	REV
A	RHS2-3124-296BS	A
SCALE: 2:1	WEIGHT:	SHEET 1 OF 1